

Engaging Global Networks in Emergency Preparedness and Response

Sarah Hess

Department for Epidemic and Pandemic Preparedness and Prevention





What is a large global network?





WHO Health in the World of Work Network

Comprising of 20+ global stakeholder networks and organizations, H-WoW represents employers, workers, businesses, supply chains, labour and public health authorities, and essential economic sectors



WHO Faith Network

A diverse group of 50+ faith leaders, faith-based organizations, academic partners and faith communities of different traditions



WHO Youth Council

Comprising of 22 youth organizations and movements.

LISTEN

to concerns, needs & experience



World Health
Organization



CONVENE

to share trustworthy information and best practices

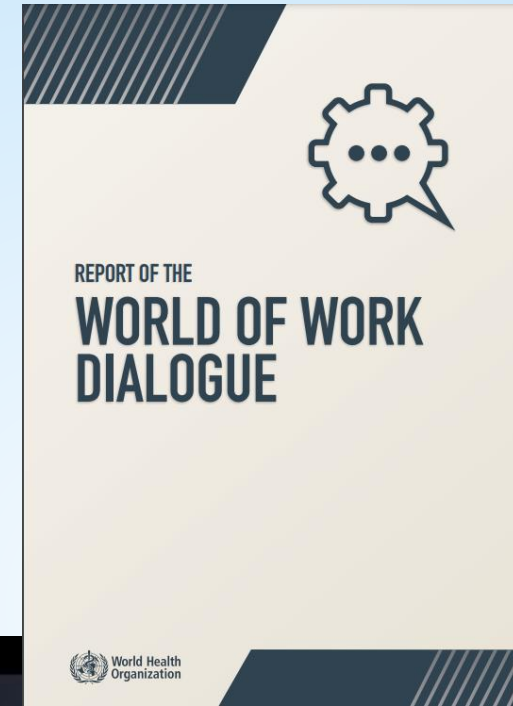

WHO Faith Network Webinar
The Importance of Language:
Faith partner resources for health emergencies

18 October 2022
1400 CEST

Speakers

- Paul Frank, PhD, Director of Professional Service Engagement, SIL International
- Mark Mutai, Senior Programme Effectiveness Manager, World Vision International, Sierra Leone
- Catherine Young, PhD, Director, Global Language and Development Services, SIL International
- Sophia Nthenda, Deputy Executive Director and Coordinator, Women of Faith Peace Building Network, Malawi
- Robert Phiri, Executive Director, Malawi Public Affairs Committee (Religions for Peace in Malawi)

World Health Organization

Powered by Zoom

CO-CREATE

evidence-based and context-specific solutions

Practical considerations and recommendations for religious leaders and faith-based communities in the context of COVID-19

Interim guidance
7 April 2020



Background

Religious leaders, faith-based organizations, and faith communities can play a major role in saving lives and reducing illness related to COVID-19.¹ They are a primary source of support, comfort, guidance, and direct health care and social service, for the communities they serve. Religious

- Ensuring safe faith-based gatherings, ceremonies, and rituals when they do occur
- Strengthening mental and spiritual health, well-being and resilience, through individual contact (while observing appropriate physical distancing) and through social and other communications media
- Ensuring that a human-rights-based approach to

COLLABORATE

for health emergency preparedness,
response and resilience

World Health Organization strategy for
engaging religious leaders, faith-based
organizations and faith communities in
health emergencies



The HIVE Platform



A digital solution to:

- Increase access trustworthy information
- Convene for knowledge sharing and collaboration
- Foster communities of practice.

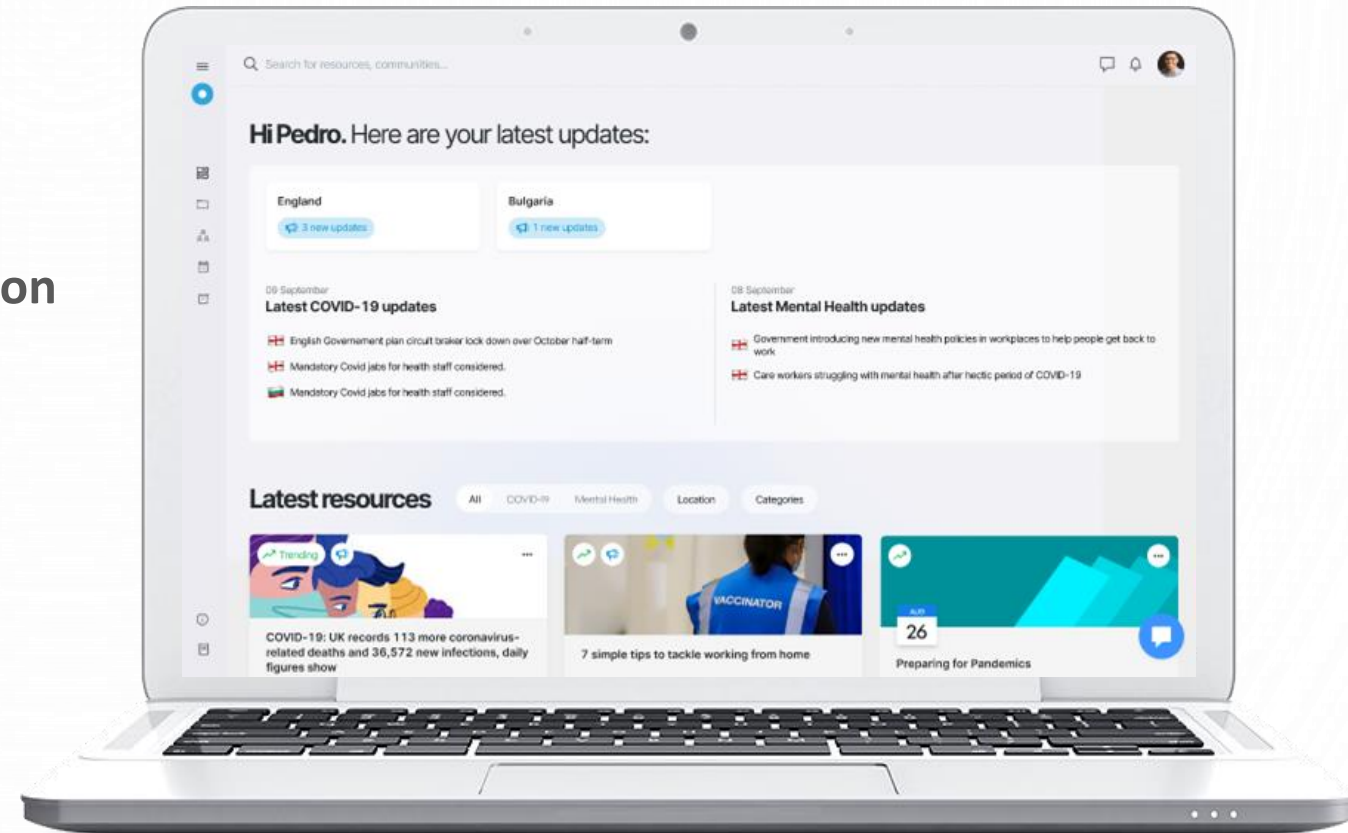

Features of Hive

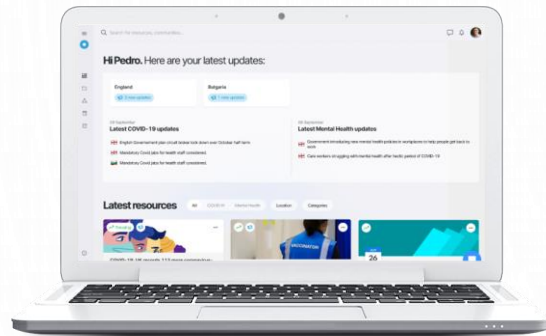

Community collaboration tools

- Chats & notifications
- Community conversation/posting based on specific topic

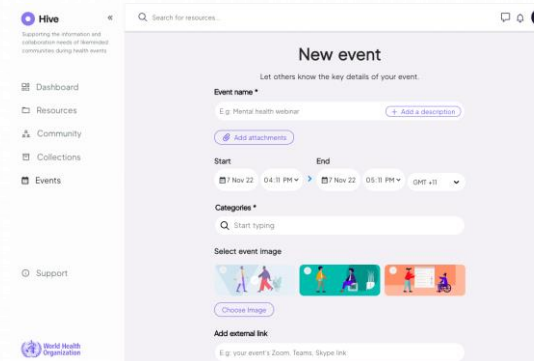

Host and attend events

- Technical briefings
- Consultations
- Working meetings

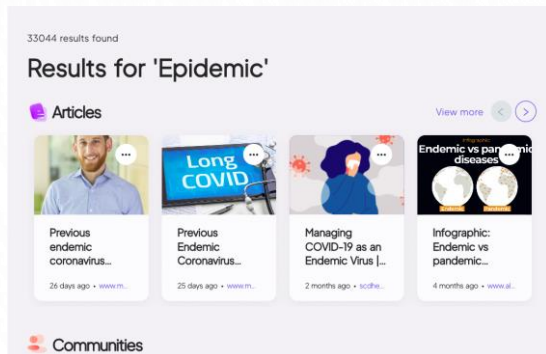

Search articles within the WHO validated sources

- AI/ML driven global information acquisition & processing
- Verified sources added from Epidemic Intelligence from Open Sources (EIOS)

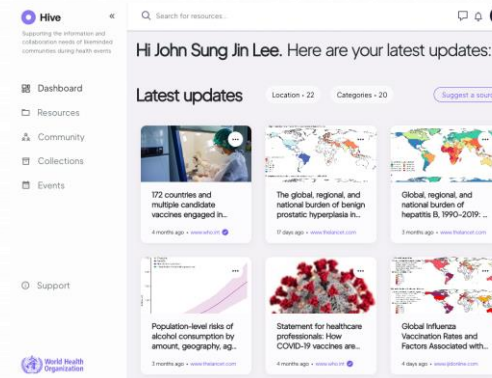

Trusted network of communities

- Community creation based on trusted network
- Support to provide feedback concerns

Key messages

